

Housing Dimensions ARR. 1, 4, 4H, 4V, 9

See page 11 for additional dimensional drawings.

Size	B		C	D	F		G	JJ		L	LL	M	a	b		c	d
	Slip	Flange			Slip	Flange		Slip	Flange					Slip	Flange		
804	7	6 ¹ / ₁₆	5 ¹¹ / ₁₆	4 ¹ / ₈	6 ¹ / ₄	8 ⁹ / ₁₆	5 ¹ / ₁₆	3	3 ³ / ₁₆	4	4	3 ⁹ / ₃₂	5 ¹ / ₄	9 ³ / ₈	10 ³ / ₈	6 ¹ / ₈	5
904	8 ¹¹ / ₁₆	7 ⁵ / ₈	7 ³ / ₈	5 ⁵ / ₈	7 ³ / ₄	10 ¹ / ₁₆	6 ¹¹ / ₁₆	3 ³ / ₁₆	3 ³ / ₈	5	4	3 ²⁵ / ₃₂	7	11 ⁵ / ₈	12 ⁹ / ₁₆	7 ¹¹ / ₁₆	6 ⁵ / ₁₆
1005	9 ¹ / ₈	8 ³ / ₁₆	8 ³ / ₈	6 ⁹ / ₁₆	9 ³ / ₁₆	12 ¹ / ₁₆	7 ¹ / ₂	3 ¹ / ₂	3 ¹¹ / ₁₆	6	5	4 ¹ / ₃₂	7 ³ / ₄	12 ⁷ / ₈	14 ³ / ₈	9	7 ¹ / ₈
1206	10 ¹ / ₁₆	9 ³ / ₁₆	9 ⁹ / ₁₆	7 ⁹ / ₁₆	10 ¹¹ / ₁₆	13 ¹ / ₁₆	8 ³ / ₈	3 ⁷ / ₈	4 ¹ / ₈	6, 7, 8	6	4 ²⁵ / ₃₂	8 ¹¹ / ₁₆	14 ⁵ / ₈	15 ³ / ₄	10 ³ / ₈	8
1406	11	10 ¹ / ₈	10 ¹ / ₄	8 ¹ / ₁₆	11 ³ / ₁₆	13 ⁹ / ₁₆	9 ¹ / ₈	4 ¹ / ₄	4 ¹ / ₂			7 ¹ / ₃₂	8	5 ¹³ / ₃₂	9 ¹ / ₂	15 ⁵ / ₈	16 ³ / ₄
1508	12	11 ¹ / ₈	10 ⁷ / ₁₆	7 ⁷ / ₈	11	14 ⁵ / ₈	9 ⁵ / ₁₆	4 ⁷ / ₈	5 ¹ / ₈	6, 8, 10	8	7 ¹ / ₃₂	10	17	18 ¹ / ₄	10 ⁷ / ₈	9 ¹¹ / ₁₆
1806	12 ⁵ / ₈	11 ³ / ₄	12 ³ / ₄	10 ¹ / ₂	13 ⁵ / ₈	16	11 ³ / ₁₆	4 ³ / ₈	4 ⁵ / ₈	6, 8, 10	6	5 ¹ / ₃₂	12 ¹ / ₁₆	18 ¹ / ₂	19 ⁵ / ₈	13 ³ / ₈	10 ¹ / ₄
1808	13 ¹ / ₁₆	12 ³ / ₁₆	13 ³ / ₁₆	9 ⁷ / ₈	14	16 ⁵ / ₈	11 ¹¹ / ₁₆	5 ⁵ / ₁₆	5 ⁹ / ₁₆	8, 10	8	7 ⁹ / ₃₂	12 ⁹ / ₁₆	19 ¹ / ₈	20 ³ / ₈	13 ¹³ / ₁₆	10 ³ / ₄

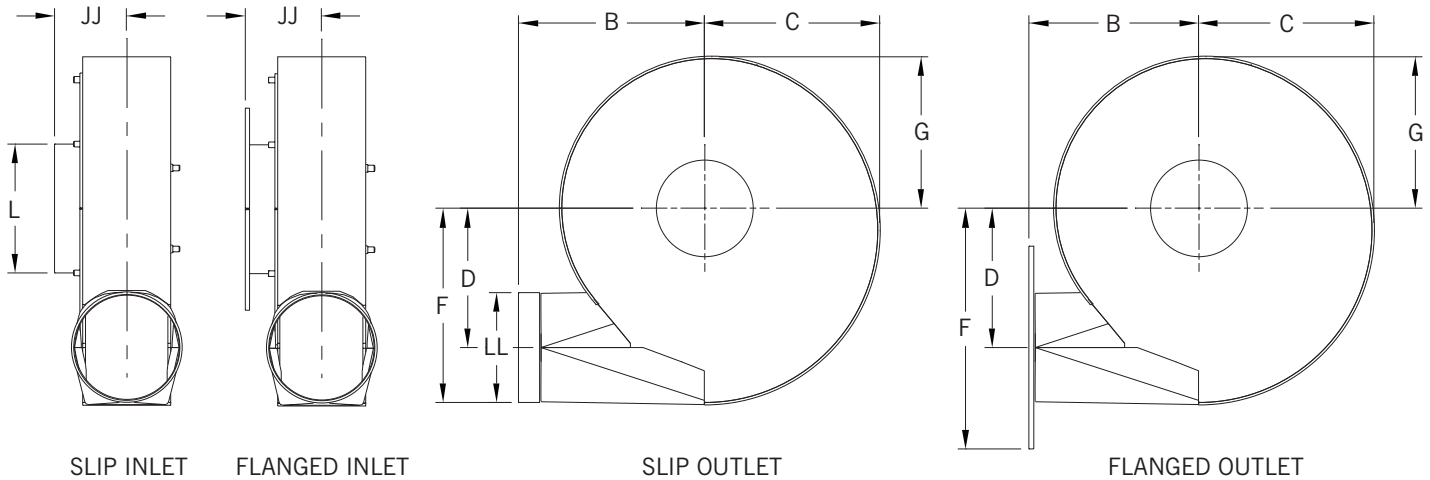

FAN DISCHARGES – VIEWED FROM DRIVE SIDE

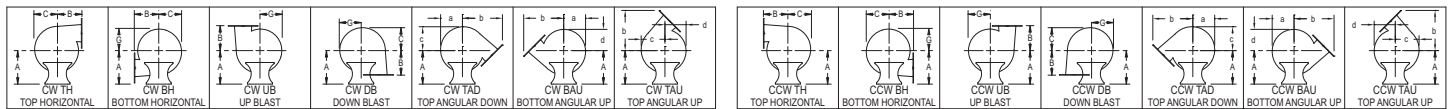

Clockwise—angular discharges at 45°

Counterclockwise—angular discharges at 45°

OPTIONAL INLET AND OUTLET FLANGES

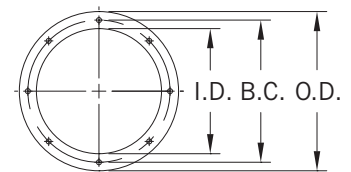

DIMENSIONS [INCHES]

Size	Usage		ID	OD	BC	GA.	Std. Flange Pattern		Optional (ANSI 150LB)	
	Inlet	Outlet					Qty. Holes	Hole Dia.	Qty. Holes	Hole Dia.
4	804	804, 904	4	9	7 ¹ / ₂	7	12	7 ¹ / ₁₆	8	3 ³ / ₄
5	904	1005	5	10	8 ¹ / ₂					7 ¹ / ₈
6	1005	—	6	11	9 ¹ / ₂	1 ¹ / ₄	8	7 ¹ / ₁₆	8	7 ¹ / ₈
	1406, 1508, 1806	1206, 1406, 1806								1
7	1206, 1406	—	7	—	9	—	—	—	—	—
8	1406, 1508, 1806, 1808	1508, 1808	8	13 ¹ / ₂	11 ³ / ₄	—	—	—	—	—
10	1508, 1806, 1808	—	10	16	14 ¹ / ₄	—	—	—	—	1

Note: Inlet flange holes are on centerline and outlet flange holes straddle centerline.

ARRANGEMENTS 1/9 DIMENSIONS

Dimensions not to be used for construction unless certified. Note: See page 11 for dimensional drawings.
Bare fan weights in lbs.

Size	Mtr. Frame	A	H		K	N	R	S	T	U	W	X	XX	YY	ZZ	Arr. 9 Belt Centers		Bare Fan Weight	
			Slip	Flange												Min.	Max.		
804	56	14	23 ³ / ₈	23 ⁵ / ₁₆	2 ¹ / ₄	16 ¹ / ₄	5 ¹⁵ / ₁₆	10 ⁵ / ₁₆	5 ¹¹ / ₁₆	6 ⁷ / ₁₆	2 ⁵ / ₁₆	1 ¹¹ / ₁₆	14 ¹ / ₂	4 ³ / ₄	20 ³ / ₁₆	11.2	11.6	59	
904	56		23 ⁹ / ₁₆	23 ³ / ₄			6 ³ / ₁₆											66	
	143/5T																	69	
1005	56		24	24 ³ / ₁₆			6 ⁵ / ₁₆											72	
	143/5T				75														
	56		24 ³ / ₄	25	6 ¹¹ / ₁₆	82													
	143/5T					85													
	182/4T	18	28 ⁷ / ₈	29 ¹ / ₈	3 ³ / ₈	19 ¹ / ₄	6 ⁵ / ₈	13 ³ / ₈	8	8 ³ / ₄	2 ³ / ₁₆	1 ⁵ / ₈	19 ¹ / ₄	8 ³ / ₄	24 ³ / ₁₆	13.8	14.3	107	
	213/5T		29 ¹ / ₁₆	29 ¹³ / ₁₆			7											114	
	56																	117	
	143/5T																	116	
	182/4T																	118	
	213/5T																	164	
	182/4T																	166	
	213/5T																	170	
	254/6T	23	38 ³ / ₄	39	4 ⁵ / ₈	25 ³ / ₄	7 ⁷ / ₈	19 ⁹ / ₈	8 ⁵ / ₈	9 ³ / ₈	1 ¹⁵ / ₁₆	1 ³ / ₄	24 ¹¹ / ₁₆	8 ³ / ₄	32 ³ / ₁₆	16.9	18.2	170	
	182/4T	18	29 ¹ / ₂	29 ³ / ₄	3 ³ / ₈	19 ¹ / ₄	6 ³ / ₄	13 ³ / ₈	8	8 ³ / ₄	2 ³ / ₁₆	1 ⁵ / ₈	19 ¹ / ₄	8 ³ / ₄	24 ³ / ₁₆	13.8	14.3	169	
	213/5T		29 ³ / ₄	29 ¹ / ₂	3 ³ / ₈	19 ¹ / ₄	6 ³ / ₄	13 ³ / ₈	8	8 ³ / ₄	2 ³ / ₁₆	1 ⁵ / ₈	19 ¹ / ₄	8 ³ / ₄	24 ³ / ₁₆	14.4	15.2	171	
	254/6T	23	37 ¹ / ₄	37 ¹ / ₂	4 ⁵ / ₈	25 ³ / ₄	7 ⁷ / ₈	19 ⁹ / ₈	8 ⁵ / ₈	9 ³ / ₈	1 ¹⁵ / ₁₆	1 ³ / ₄	24 ¹¹ / ₁₆	8 ³ / ₄	32 ³ / ₁₆	16.9	18.2	175	
	182/4T	18	31 ⁹ / ₁₆	31 ¹³ / ₁₆	3 ³ / ₈	19 ¹ / ₄	7 ⁷ / ₈	13 ³ / ₈	8	8 ³ / ₄	2 ³ / ₁₆	1 ⁵ / ₈	19 ¹ / ₄	8 ³ / ₄	24 ³ / ₁₆	13.8	14.3	188	
	213/5T		31 ¹ / ₁₆	31 ⁵ / ₁₆	3 ³ / ₈	19 ¹ / ₄	7 ⁷ / ₈	13 ³ / ₈	8	8 ³ / ₄	2 ³ / ₁₆	1 ⁵ / ₈	19 ¹ / ₄	8 ³ / ₄	24 ³ / ₁₆	14.4	15.2	189	
	254/6T		23	39 ⁵ / ₁₆	39 ⁹ / ₁₆	4 ⁵ / ₈	25 ³ / ₄	8	19 ¹ / ₂	8 ⁵ / ₈	9 ³ / ₈	1 ¹⁵ / ₁₆	1 ³ / ₄	24 ¹¹ / ₁₆	8 ³ / ₄	32 ³ / ₁₆	16.9	18.2	194
	284/6T					4 ⁵ / ₈	25 ³ / ₄	8	19 ¹ / ₂	8 ⁵ / ₈	9 ³ / ₈	1 ¹⁵ / ₁₆	1 ³ / ₄	24 ¹¹ / ₁₆	8 ³ / ₄	32 ³ / ₁₆	17.3	18.9	195

ARRANGEMENT 4 DIMENSIONS

Size	Mtr. Frame	A	H		HH		N	NN	O	R	S	T	U	W	X	Base Holes	Bare Fan Weight
			Slip	Flange	Slip	Flange											
804	56	8 ⁹ / ₁₆	11 ³ / ₄	11 ¹⁵ / ₁₆	15 ³ / ₈	15 ⁹ / ₁₆	7 ¹ / ₈	8 ¹⁵ / ₁₆	7 ³ / ₄	3 ³ / ₁₆	5	2 ³ / ₄	3 ¹ / ₂	12 ¹ / ₄	3 ⁴ / ₈		35
	56	10 ⁷ / ₁₆	12 ³ / ₁₆	12 ³ / ₈	15 ¹³ / ₁₆	16	7 ¹ / ₈	9 ⁷ / ₈	8 ³ / ₄	3 ³ / ₈	5 ³ / ₄			5 ³ / ₄			4 ¹ / ₂
	143/5T	11 ⁷ / ₈	13 ¹⁵ / ₁₆	14 ¹ / ₈	18 ¹ / ₁₆	18 ¹ / ₄	8 ⁷ / ₈	10 ¹⁵ / ₁₆	9	4 ³ / ₁₆	5	3 ³ / ₄	4 ¹ / ₂	14 ¹ / ₂	13 ¹ / ₄		49
	56	10 ⁷ / ₁₆	12 ⁵ / ₈	12 ¹³ / ₁₆	16 ¹ / ₄	16 ⁷ / ₁₆	7 ¹ / ₈	9 ¹⁵ / ₁₆	8 ³ / ₄	3 ⁷ / ₁₆	5 ³ / ₄	2 ³ / ₄	3 ¹ / ₂	12 ¹ / ₄	3 ⁴ / ₈		56
	143/5T	11 ⁷ / ₈	14 ³ / ₈	14 ⁹ / ₁₆	18 ¹ / ₂	18 ¹¹ / ₁₆	8 ⁷ / ₈	11	9 ¹ / ₄	4 ¹ / ₄	5	3 ³ / ₄	4 ¹ / ₂	14 ¹ / ₂	13 ¹ / ₄		59
	56	11 ⁷ / ₈	13 ³ / ₈	13 ⁵ / ₈	17	17 ¹ / ₄	7 ¹ / ₈	10	8 ¹ / ₂	5	3 ³ / ₄	4 ¹ / ₂	12 ¹ / ₄	3 ⁴ / ₈			70
	143/5T		15 ¹ / ₈	15 ³ / ₈	19 ¹ / ₄	19 ¹ / ₂	8 ⁷ / ₈	11 ³ / ₈	9 ³ / ₄								4 ⁵ / ₈
	182/4T		16 ¹ / ₄	16 ¹ / ₂	19 ³ / ₄	20	14 ¹ / ₂	12 ¹ / ₄	5				15	15			76
	56		14 ¹ / ₁₆	14 ⁵ / ₁₆	17 ¹¹ / ₁₆	17 ¹⁵ / ₁₆	7 ¹ / ₈				8 ³ / ₄	4 ¹⁵ / ₁₆	5 ¹¹ / ₁₆	12 ¹ / ₄	14 ¹ / ₂	13 ¹ / ₄	90
	143/5T	15 ³ / ₁₆	15 ¹³ / ₁₆	16 ¹ / ₁₆	19 ¹⁵ / ₁₆	20 ³ / ₁₆	8 ⁷ / ₈	15	12 ³ / ₄	5 ¹ / ₂	6 ¹ / ₈	4 ¹⁵ / ₁₆	5 ¹¹ / ₁₆	14 ¹ / ₂	15	91	
	182/4T	16 ¹⁵ / ₁₆	17 ³ / ₁₆	20 ¹ / ₁₆	20 ¹¹ / ₁₆	10								13	15	19	23 ⁷ / ₈
	182/4T	15 ³ / ₁₆	18 ³ / ₈	18 ⁵ / ₈	21 ⁷ / ₈	22 ¹ / ₈	10	15 ⁵ / ₈	13 ³ / ₄	6 ¹ / ₈	4 ¹⁵ / ₁₆	5 ¹¹ / ₁₆	15	19	113		
	213/5T		20 ¹ / ₂	20 ³ / ₄	25 ¹³ / ₁₆	26 ¹ / ₁₆	12 ¹ / ₈		12 ¹ / ₂				15 ¹ / ₂	13	15	23 ⁷ / ₈	118
	254/6T		24 ³ / ₈	24 ⁵ / ₈	30 ¹¹ / ₁₆	30 ¹⁵ / ₁₆	16	19 ⁷ / ₈	15 ¹ / ₂	12 ³ / ₄	8 ³ / ₄	13	15	23 ⁷ / ₈	119		
	182/4T		16 ⁷ / ₈	17 ¹ / ₈	20 ³ / ₈	20 ⁵ / ₈	10	15 ¹ / ₈	12 ³ / ₄	12	5 ⁵ / ₈	8 ³ / ₄	13	19	23 ⁷ / ₈	126	
	213/5T	15 ³ / ₁₆	19	19 ¹ / ₄	24 ⁵ / ₁₆	24 ⁹ / ₁₆	12 ¹ / ₈	15 ¹ / ₈	12	6 ¹ / ₂	10 ³ / ₄	6 ¹ / ₄	7	19	156		
	254/6T		22 ⁷ / ₈	23 ¹ / ₈	29 ³ / ₁₆	29 ⁷ / ₁₆	16	19 ³ / ₈	15 ¹ / ₂					13	15 ³ / ₄	23 ⁷ / ₈	157
	182/4T		18	18 ¹⁵ / ₁₆	19 ¹ / ₁₆	22 ⁷ / ₁₆	22 ¹¹ / ₁₆	10	18	16	6 ¹ / ₂	10 ³ / ₄	6 ¹ / ₄	7	15	153	
	213/5T			21 ¹ / ₁₆	21 ⁵ / ₁₆	26 ³ / ₈	26 ⁷ / ₈	12 ¹ / ₈							18	16	19
	254/6T	24 ¹⁵ / ₁₆		25 ³ / ₁₆	31 ¹ / ₄	31 ¹ / ₂	16	23	18 ¹ / ₄	16	15 ³ / ₄	23 ⁷ / ₈	157				
	284/6T		26 ³ / ₄	27	33 ⁵ / ₈	33 ⁷ / ₈	17 ¹³ / ₁₆							26 ¹ / ₄	158		

ARRANGEMENTS 4H/4V DIMENSIONS

Size	Mtr. Frame	HH	Bare Fan Weight
804	56C	15 ⁹ / ₁₆	26
904	56C	16	36
	143/5TC	18 ¹ / ₄	
1005	56C	16 ⁷ / ₁₆	43
	143/5TC	18 ¹¹ / ₁₆	
1206	56C	17 ¹ / ₄	58
	143/5TC	19 ¹ / ₂	
	182/4TC	20	
1406	56C	17 ¹⁵ / ₁₆	79
	143/5TC	20 ³ / ₁₆	
	182/4TC	20 ¹¹ / ₁₆	

Size	Mtr. Frame	HH	Bare Fan Weight
1508	182/4TC	22 ¹ / ₈	82
	213/5TC	26 ¹ / ₁₆	
	254/6TC	30 ¹⁵ / ₁₆	
1806	182/4TC	20 ⁵ / ₈	86
	213/5TC	24 ⁹ / ₁₆	
	254/6TC	29 ⁷ / ₁₆	
1808	182/4TC	22 ¹¹ / ₁₆	113
	213/5TC	26 ⁵ / ₈	
	254/6TC	31 ¹ / ₂	
	284/6TC	33 ⁷ / ₈	

Housings are rotatable in 22¹/₂° increments except Bottom Angular Down which requires special construction.

The New York Blower Company has a policy of continuous product development and reserves the right to change designs and specifications without notice.

ARRANGEMENTS

1/9

PRESSURE BLOWERS

Maximum Airstream Temperature:
 200°F. – aluminum wheel.
 300°F. – steel wheel.
 600°F. – heat fan.

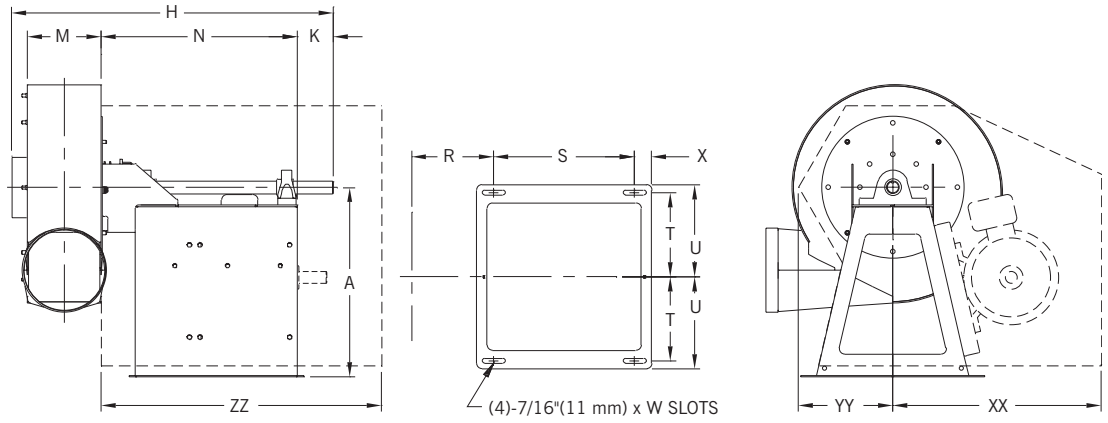

ARRANGEMENT

4

PRESSURE BLOWERS

Maximum Airstream Temperature:
 180°F.

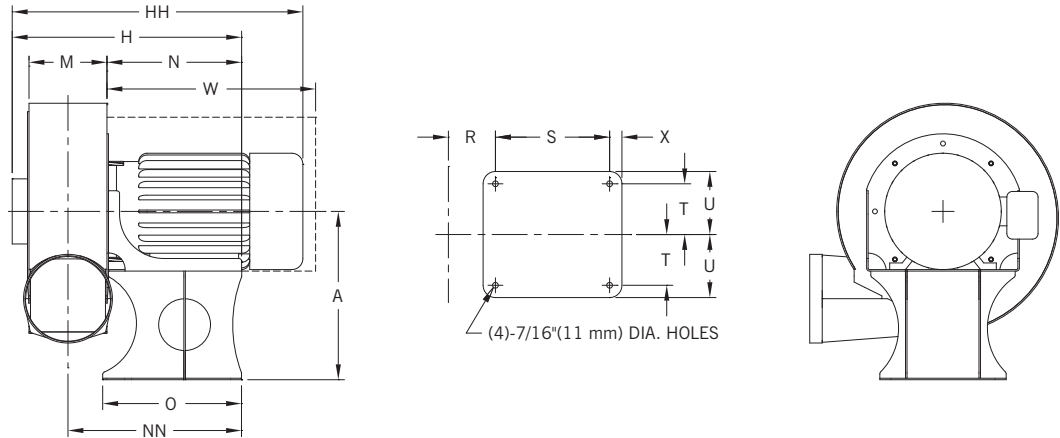

ARRANGEMENT

4-V

PRESSURE BLOWERS

Maximum Airstream Temperature:
 120°F.

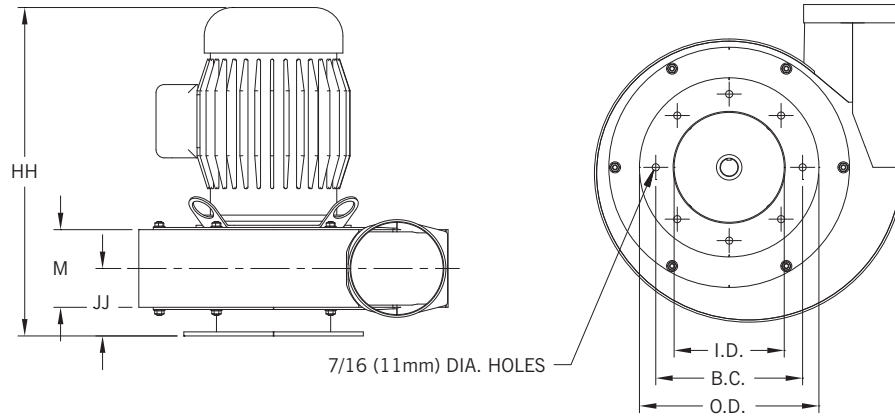

ARRANGEMENT

4-H

PRESSURE BLOWERS

Maximum Airstream Temperature:
 120°F.

